

The CONEXX-GROUP is a group of companies located all over Europe that have been operating on the market since 1957.

The companies deal with engineering, production and installation of turn key objects all over Europe and under the “build it yourself” system. The management of the companies are composed from an international staff.

The buildings sold by us are easy to assemble so that the customer could assembly them himself under the BIY (build it yourself) system.

All our buildings are of a double-sloped roofs type. Besides, our building-range is divided into 3 different kinds:

ü **BASIC-LINE** (cheap ware-houses in a width up to 23 metres)

ü **COMFORT-LINE** (buildings for animals, insulated and none-insulated)

ü **HIGH-LINE** (more expensive ware-houses and industry-buildings)



The building of the “**BASIC-LINE**” type has a double-sloped roof and is classified as a cheap warehouse up to 23 metres in width.

Additionally, there is always a quick response to the customer’s needs. It should be mentioned that all products manufactured by us are of the highest quality. Buildings all over the world are the best proof of our professionalism. All this to meet the customer’s requirements fully.

All products will be delivered as prefabricated units, which just have to be assembled. Within the construction package the customer receives the anchors necessary to found the construction, the steel construction, which just has to be screwed together with bolts and nuts (provided in the package), cut to size elements of the walls and roof and sliding gates.

The offer does not include floors and infrastructure.

This form of delivery guarantees efficient and quick assembly in stages, which shall be described in detail further on.

GENERAL INFORMATION ON THE ASSEMBLY OF DOUBLE-SLOPED ROOF HALL SYSTEM

Concrete spot footing:

The type of the applied footing is called “feetplate with concrete column”.

The concrete spot footing, on which the building will be founded are made from reinforced concrete.



Steel construction:

The constructions offered by us are made up to 23 metres in width; they do not have to be supported inside the building by any pillar, which enables to utilise the space under the roof effectively.

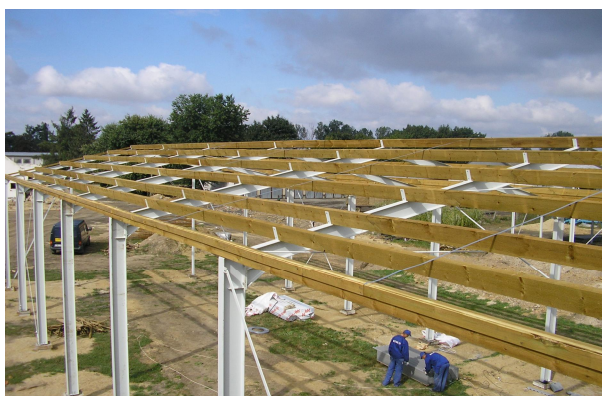

The steel construction can be essentially divided into three types of frames: front, rear and repeatable frames, which shall be mounted between the front and rear frames. Their quantity depends on the length of the building, the usual distance used between the individual frames is about 5 metres.

The auxiliary pillars are mounted in the frame of the front wall, which facilitate the installation of the sliding gates, which can be ordered at any size.

Roof and wall purlins:

The roof and wall purlins are made both from wood.

The purlins have special pin ends, which enables them to take the compression and tension forces.

Roof, walls and gutters:

We propose the following range of products for roofing and wall panelling:

1. Roofing corrugated cement fibreboards
2. Roofing corrugated cement fibreboards + insulation
3. Wall sheets
4. Wall sheets + insulation
5. Steel gutters

(1). Corrugated cement fibreboards):

Light and easy to assemble, successfully replaces the old type of asbestos panelling harmful to health and environment, while at the same time offering many advantages.

(2). Corrugated cement fibreboards + insulation:

These fibreboards are mounted with additional insulation material called “Selthaan” and is available in different thicknesses.

(3). Wall sheet:

These are zinc-plated sheets with painted organic layer. All finishing sheets will be made from the same material.

(4). Wall sheet + insulation:

These sheets are mounted with additional insulation material called “Selthaan”, which is available in wide range of thickness.

(5). Gutters:

These gutters are made from zinc-plated sheets with painted organic layer.



Sliding-gates:

Customer has a wide range of capabilities of place selection, in which gates can be located.

The sliding-doors are made from a material-combination of a steel frame and wooden covering.

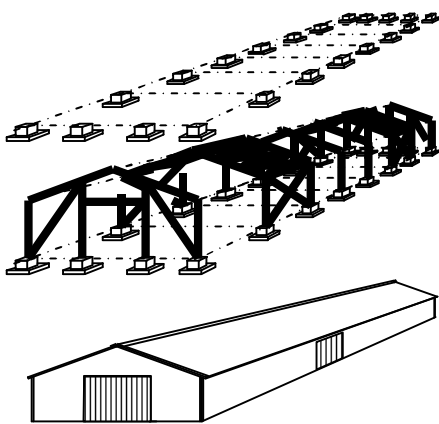

Pricing, buying and other services:

For pricing, buying and other services we have developed a special program which gives the possibility to sell without overhead-costs. This results that “BASIC-LINE” is a cheap and quick product, without making concessions in quality.

The program is working with different snow loads (80kg/m² up to 200kg/m²) for the buildings in a width up to 23 meters and a highness in the eaves up to 6 metres. So the possibilities are big and the prices are low.

Drawings, head-calculations and other documents are ready within 2 working-days after receiving the order. They are prepared in a language required by the customer, which is needed to get his building licence.

You are welcome to call our dealer to arrange a meeting or present an offer, they can provide you with any information, cost estimate, documents and drawings required by you really quickly. Contacting our network will enable quick and cheap implementation of your building project.

CONEXX-GROUP	OUR DEALER
CONEXX-NETHERLANDS CONEXX-POLAND CONEXX-BALTIC CONEXX-RUSSIA CONEXX-SCANDINAVIA	